

# Neillsville ... fun in the northwoods!

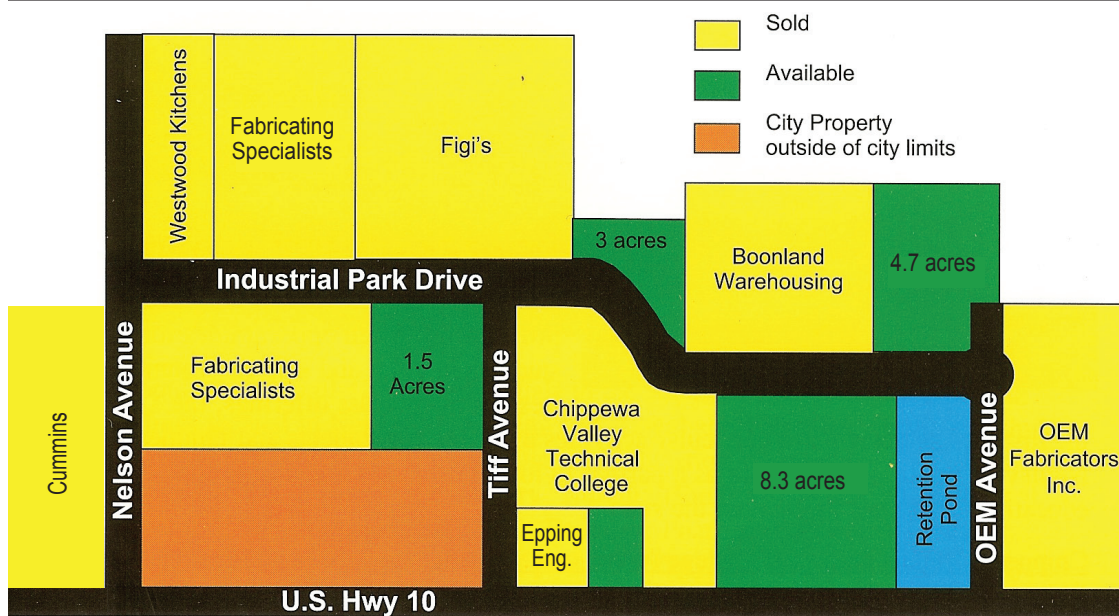

Not to scale, artist rendition only

## SITE DESCRIPTION

The Neillsville Industrial Park is located in West Central Wisconsin's Clark County along U.S. Highway 10. The Park consists of 67 acres with 22.6 acres currently available. Thirty acres of adjacent property are also available and planned for industrial development.

## Site Specifications

### SITE INFORMATION

Available Acres	22.6
Future Expansion Acres	30
Zoning	General Industrial

### TRANSPORTATION

Nearest major highway	US Hwy 10 / I-94
Distance to nearest highway	Adjacent / 28 miles
Lanes	2 / 4
Nearest comm. airport	Eau Claire / Mosinee
Distance to airport	55 miles / 59 miles
Runways – over 1700'	4 miles
Rail	No

### UTILITIES

Electricity supplier	Xcel Energy
3-phase electric	Yes
Gas supplier	WE Energies
Municipal water	Yes
Municipal sewer	Yes
Stormwater	Yes

### TELECOMMUNICATIONS

Fiber optics	Yes
--------------	-----

### MEDICAL

Medical	Yes
- Memorial Medical Center, 40 bed hospital, 24-hr. ER	
- Marshfield Medical Center – 28 miles	
- St. Joseph's Hospital – 28 miles	
- National Farm Medicine Center – 28 miles	
- Ministry Health Care – 28 miles	
- Marshfield Clinic Research Foundation – 28 miles	
- Marshfield Dental Clinic - < 1 mile	

### INCENTIVES

Multiple Local, State, and Federal funding opportunities	
- NMTC Qualified	- Regional Business Fund
- WI Tax Credit Program	- WHEDA/USDA/WBD
- Labor training & others	

### TERMS

Below market interest rates which may be fixed for the term of the loan. Deferrals of principal and/or interest payments may be allowed for a brief period of time. Terms can be up to five years on working capital loans, seven to ten years on machinery and equipment, and 12 years on real estate with an option of eight additional years. Collateral is required.

### TOP EMPLOYERS

- Memorial Medical Center	- OEM
- Clark County Government	- Cummins
- Neillsville Public Schools	- Fabricating Specialists

### CONTACT

Sheila M. Nyberg  
Executive Director  
Clark County Economic  
Development Corporation  
301 N. Main St.  
P.O. Box 236  
Loyal, WI 54446  
Phone: 715-255-9100  
Fax: 715-255-9153  
sheila@clark-cty-wi.org  
www.clark-cty-wi.org

Steve Mabie  
Mayor of Neillsville, WI  
118 W. 5th St.  
Neillsville, WI 54456  
Phone: 715-743-2105  
Fax: 715-743-2727  
neills@tds.net  
www.neillsville-wi.com



# City of Neillsville -- *Industrial Park*



**City of Neillsville**  
 118 W. 5th St.  
 Neillsville, WI 54456  
 715-743-2105  
[www.neillsville-wi.com](http://www.neillsville-wi.com)

Neillsville is located where U.S. Hwy. 10 and State Hwy. 73 intersect. Neillsville, the county seat, is a great place to visit whether you are an outdoor enthusiast, history buff, wildlife watcher or hunter, shopper or sight-seer. Neillsville has a Historic Downtown with 20 buildings listed in the State and National Historic Registers. You'll enjoy Downtown specialty shops, antique shops and a restaurant. Visitors are drawn to The Highground Veterans Memorial Park, 1897 Clark County Jail Museum, Tufts'

Mansion, WCCN's Wisconsin Pavilion, Chatty Belle—the World's Largest Talking Cow, Listeman Arboretum, and Reed School, listed as Wisconsin's Historical Society's 10th site. Other activities include Neillsville Heritage Days, Clark County Fair and the Winter Carnival. Neillsville offers several motels, a historic bed and breakfast, a number of fine dining restaurants, a 9-hole golf course, six parks, a skateboard park, tennis and volleyball courts, ball diamonds, and an airport. Amish homes and businesses dot the

countryside. Surrounding Neillsville is an abundance of recreational opportunities: Clark County ATV, off-road motorcycle, snowmobile, mountain biking trails, area horseback riding, county campgrounds, public hunting land, Bruce Mound Winter Sports Area and Levis/Trow Mound Recreational Area. The friendly residents of Neillsville welcome you to visit for a day, a week, or a lifetime.

[www.neillsville-wi.com](http://www.neillsville-wi.com).

## Travel Time to Neillsville, WI

To and from Neillsville	Miles
Eau Claire, WI	53
Wausau, WI	74
Minneapolis/St. Paul, MN	146
Madison, WI	154
Green Bay, WI	158
Milwaukee, WI	214
Chicago, IL	297

