

Neillsville ... fun in the northwoods!

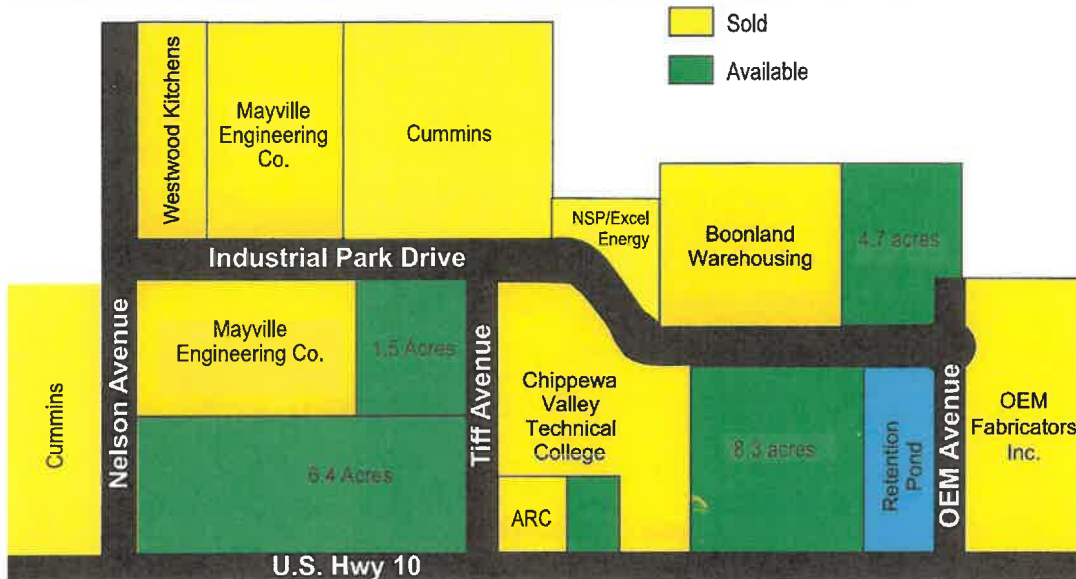

Not to scale, artist rendition only

SITE DESCRIPTION

The Neillsville Industrial Park is located in West Central Wisconsin's Clark County along U.S. Highway 10. The Park consists of 67 acres with 20.9 acres currently available. Thirty acres of adjacent property are also available and planned for industrial development.

Site Specifications

SITE INFORMATION

Available Acres	20.9
Future Expansion Acres	30
Zoning	General Industrial
Broadband	Yes

TRANSPORTATION

Nearest major highway	US Hwy 10 / I-94
Distance to nearest highway	Adjacent / 28 miles
Lanes	2 / 4
Nearest regional airport	Eau Claire / Mosinee
Distance to airport	55 miles / 59 miles
Nearest local airport	Neillsville
Runways – over 1700'	4 miles
Rail	No

UTILITIES

Electricity supplier	Xcel Energy
3-phase electric	Yes
Gas supplier	WE Energies
Municipal water	Yes
Municipal sewer	Yes
Stormwater	Yes

TELECOMMUNICATIONS

Fiber optics	Yes
--------------	-----

MEDICAL

- Marshfield Medical Center - Neillsville, 32 bed hospital, 24-hr. ER	
- Marshfield Medical Center - Marshfield	28 mi
- National Farm Medicine Center	28 mi
- Marshfield Clinic Research Institute	28 mi
- Marshfield Dental Clinic	< 1 mi

INCENTIVES

Multiple Local, State, and Federal funding opportunities	
- NMTC Qualified	- RBF Revolving Loan Fund
- WHEDA/USDA/WBD	- Labor training & others
- WEDC	- WI Financing & Tax Credit Programs

TERMS—RBF - Revolving Loan Fund

Below market interest rates which may be fixed for the term of the loan. Deferrals of principal and/or interest payments may be allowed for a brief period of time. Terms can be up to five years on working capital loans, seven to ten years on machinery and equipment, and 12 years on real estate. Collateral is required.

TOP EMPLOYERS

- Marshfield Medical Center	- OEM Fabricators, Inc.
- Cummins	- Neillsville Public Schools
- Clark County Government	- Mayville Engineering Co.

CONTACT

Sheila M. Nyberg
Executive Director
Clark County Economic
Development Corporation
301 N. Main St.
P.O. Box 236
Loyal, WI 54446
Phone: 715-255-9151
Fax: 715-255-9153
sheila@clarkcountyedc.org
www.clarkcountywi.org

Duane G. Poeschel
Mayor of Neillsville, WI
106 W. Division St.
Neillsville, WI 54456
Phone: 715-743-2105
Fax: 715-743-2727
clerk@neillsville-wi.com
www.neillsville-wi.com

City of Neillsville -- *Industrial Park*



City of Neillsville
 106 W. Division St.
 Neillsville, WI 54456
 715-743-2105
www.neillsville-wi.com

Neillsville, a Discover Wisconsin 2013 Choice Destination, is a unique community nestled in the rolling hills of central Wisconsin surrounded by natural beauty, with strong historical and cultural roots. Neillsville is a great place to visit or to call home. Whether you're an outdoor enthusiast, history buff, wildlife watcher, antique shopper, or sight-seer, you are sure to enjoy all Neillsville has to offer. Located in rural Wisconsin, Neillsville offers many amenities in a small town atmosphere, with the metro areas of Minneapolis/St. Paul, Madison, and Milwaukee all within a convenient distance. Neillsville has a historic downtown, with 20 buildings listed in the State and National Historic Registers. The

downtown area is home to specialty shops, antique shops and restaurants. Visitors are drawn to The Highground Veterans Memorial Park, 1897 Clark County Jail Museum, Tufts' Mansion, WCCN's Wisconsin Pavilion, Chatty Belle – the World's Largest Talking Cow, Listeman Arboretum, and Reed School – listed as the Wisconsin Historical Society's 10th site. A few of the fun events happening in Neillsville are Heritage Days, Clark County Fair, Winter Carnival and Fall Harvest Days. Neillsville offers several motels, two historic bed and breakfasts, a number of fine dining restaurants, and an airport. The Neillsville School District and Chippewa Valley Technical College offer high quality education to Neillsville

residents. Amish homes and businesses dot the countryside throughout Clark County. Outdoor recreation opportunities abound! Neillsville boasts an award winning 9-hole golf course and six well-kept parks that are home to a skateboard park, tennis and volleyball courts and ball diamonds. Surrounding Neillsville are Clark County ATV, off-road motorcycle, snowmobile, mountain biking and horseback riding trails, Black River canoeing and tubing, Bruce Mound Winter Sports Area, Levis/Trow Mound Recreational Area, county campgrounds, and public hunting lands. The friendly residents of Neillsville welcome you to visit for a day, a week, or a lifetime.

Travel Time to Neillsville, WI

To and from Neillsville	Miles
Eau Claire, WI	53
Wausau, WI	74
Minneapolis/St. Paul, MN	146
Madison, WI	154
Green Bay, WI	158
Milwaukee, WI	214
Chicago, IL	297

